

# Automatic Rounding Machine

RBA 42 - RBA 120

.: ROUNDING

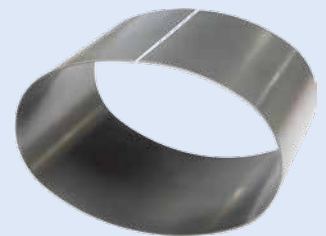

## Design features

- Four roller design with high performance rollers
- Positioning of the rollers motor driven, infinitely variable
- Sheet thickness adjustment motor driven
- Pneumatically operated bearing cap and sheet metal stops
- Numerically controlled (NC) machine with operable touch screen
- Program memory for 200 programs (50 steps/program)
- Power fail save data storage
- Password protection for data storage
- Individual program settings for different tube profiles
- Compact and easy machine design to maintain
- Infinitely variable variable 4 roll drive
- Tempered rolls with crowning curve

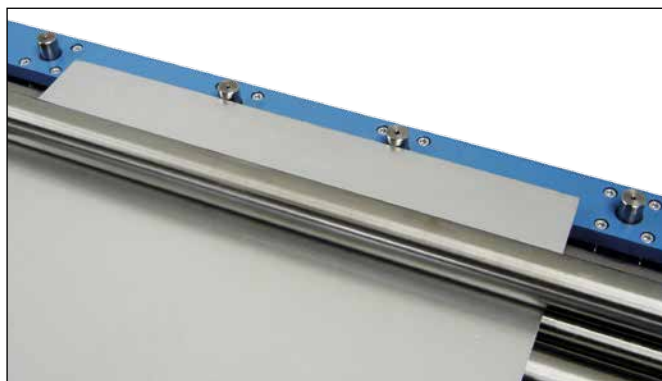

Sheet metal stop, pneumatically

## Special equipment

- Surface hardened rollers
- Grinded rollers
- Pneumatically operated tube ejector
- Tube support on back side of the machine, for big diameters
- Tube support on top of the machine, manual or NC controlled
- Possibility to change the upper roll
- High speed version with servo drives



Tube ejector, pneumatically

## Technical data

Model		RBA 42/53	RBA 52/53	RBA 52/103	RBA 60/103	RBA 70/103
Usable length	mm	530	530	1030	1030	1030
Sheet thickness (400 N/mm <sup>2</sup> )	mm	1,0	1,5	1,2	1,5	1,8
Ø Top roller	mm	42	52	52	60	70
Drive speed	m/min	0 - 8	0 - 10	0 - 10	0 - 10	0 - 12
Power	kw	2,4	2,4	2,4	2,4	4,8

Model		RBA 85/103	RBA 85/153	RBA 100/103	RBA 100/153	RBA 120/103
Usable length	mm	1030	1530	1030	1530	1030
Sheet thickness (400 N/mm <sup>2</sup> )	mm	2,5	1,8	3,2	2,4	4,5
Ø Top roller	mm	85	85	102	102	120
Drive speed	m/min	0 - 14	0 - 14	0 - 14	0 - 14	0 - 14
Power	kw	4,8	4,8	8,5	8,5	8,5

Further models and versions available on request!

[www.prinzing.eu](http://www.prinzing.eu)

**Prinzing**  
 ■ MASCHINENBAU ■

Peter Prinzing GmbH, Maschinenbau  
 Siechenlach 2  
 89173 Lonsee-Urspring (Germany)

Telefon: +49 7336 96100  
 Telefax: +49 7336 9610-50  
 E-Mail: info@prinzing.eu

